

ACCESSORIES

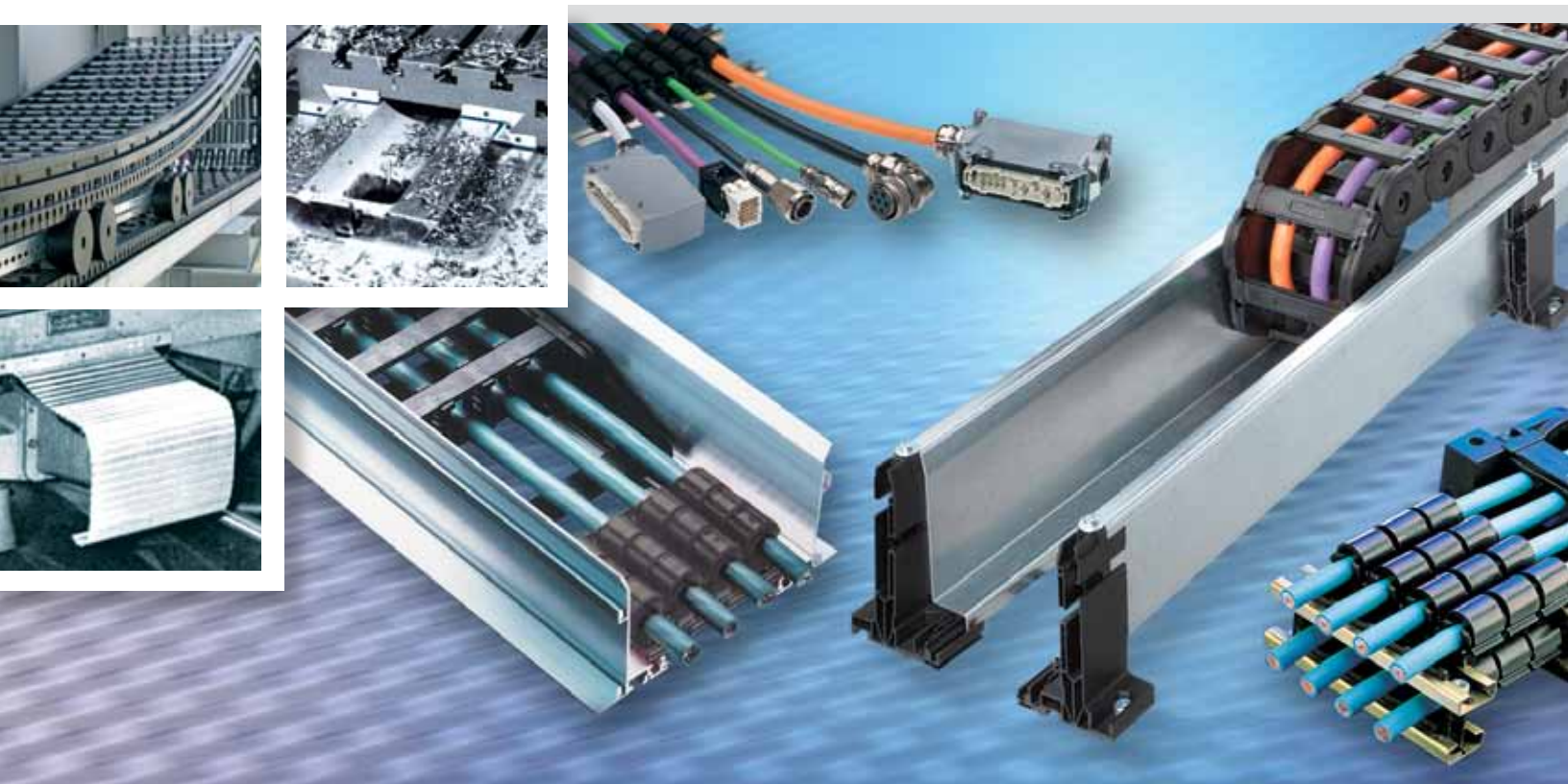

KABELSCHLEPP

Accessories to complete your system:

Strain Relief Systems

- KabelClamp^{KS} SZL Strain Relief Clamps
- Comb Style UNI Tie Wrap Strain Reliefs
- DIN Rails/U-Channels

Carrier Support and Guidance Systems

- Support Rollers
- Support Trays
- Guide Channels
- KabelSkate^{KS}
- DynaGlide^{KS}
- Rolling Carriage Systems
- ECC - Emergency Cable Carrier system

Guideway Protection Systems

- Way Wipers
- Telescopic Box Cover Wipers
- Conical Spring Covers
- Armored Apron Covers

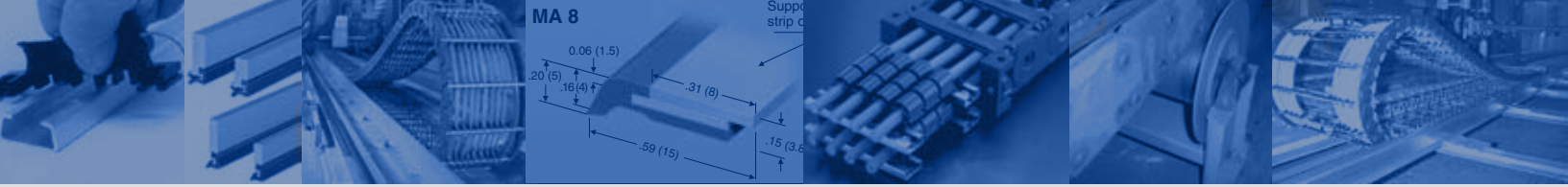

KabelClamp^{KS} Cable & Hose Strain Relief & Clamping Systems

Type: SZL

- Patented design developed for high speed systems
- No tie-wraps required
- Quick and easy to use and install
- Can be properly fastened around cables without tools
- Vibration resistant
- Distributes clamping load evenly along cable jacket
- Prevents dangerous damage to cable jackets
- Can be bolted into place or snapped into DIN/U-Channels



Call your KabelSchlepp factory representative at **1-800-443-4216** for complete information and design assistance!

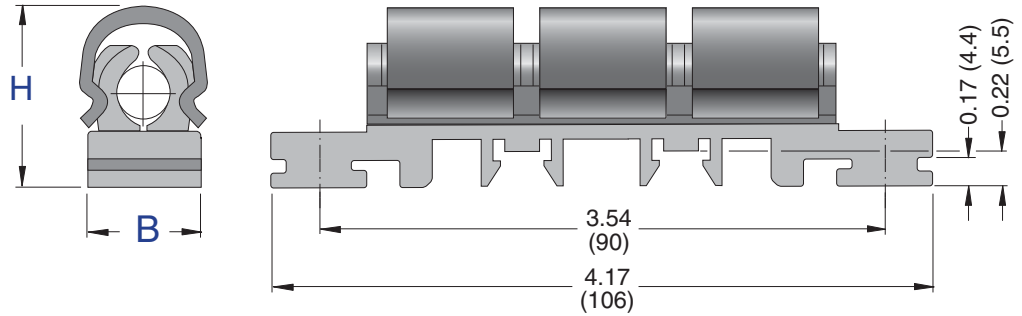

Dimensions in inches (mm)



Type	Part #	Corresponding Cable/Hose Sizes	Width B at		Height "H"
			Ø Min	Ø Max	
SZL 8	24989	Min. of Ø 0.20" (5 mm) to max. Ø 0.31" (8 mm)	0.63 (16)	0.63 (16)	1.10 (28)
SZL 10	24990	Min. of Ø 0.31" (8mm) to max. Ø 0.41" (10.5 mm)	0.79 (20)	0.79 (20)	1.18 (30)
SZL 14	24991	Min. of Ø 0.41" (10.5 mm) to max. Ø 0.57" (14.5 mm)	0.91 (23)	1.02 (26)	1.38 (35)
SZL 18	24992	Min. of Ø 0.57" (14.5 mm) to max. Ø 0.71" (18 mm)	0.98 (25)	1.26 (32)	1.57 (40)
SZL 22	24993	Min. of Ø 0.71" (18mm) to max. Ø 0.87" (22 mm)	1.18 (30)	1.42 (36)	1.73 (44)
SZL 27	24994	Min. of Ø 0.87" (22 mm) to max. Ø 1.06" (27 mm)	1.34 (34)	1.54 (39)	1.97 (50)
SZL 32	24995	Min. of Ø 1.06" (27 mm) to max. Ø 1.26" (32 mm)	1.54 (39)	1.73 (44)	2.20 (56)



KabelClamp SZL strain relief devices can be mounted to a single DIN Rail using DIN rail PN: 3932.



KabelClamp SZL strain relief devices can be mounted using a double DIN rail configuration using DIN rail PN: 3931. This DIN rail also allows strain relief to be stacked.

Please call your KabelSchlepp factory representative at **1-800-443-4216** for design assistance!

KabelClamp^{KS} systems install as easy as 1, 2, 3!

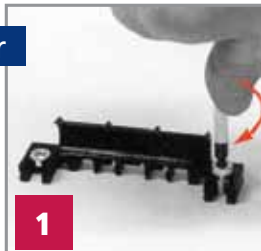
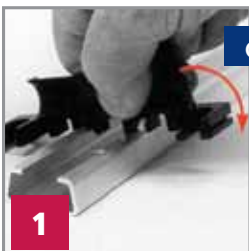

Specifications are subject to change without notice. KSA-0810-GC

COMB Style Tie Wrap Strain Relief

Type: UNI

- Inexpensive, simple and effective
- Bolt down style for use with cable ties
- Quick and easy to use and install
- Numerous sizes to choose from
- Can be used end-to-end and stacked

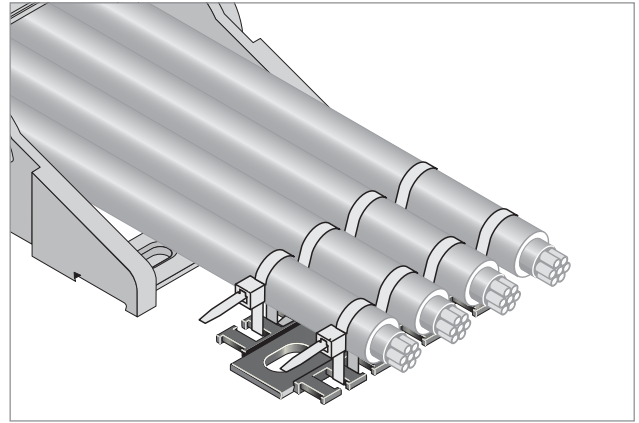

Call your KabelSchlepp factory representative at 1-800-443-4216 for complete information and design assistance!

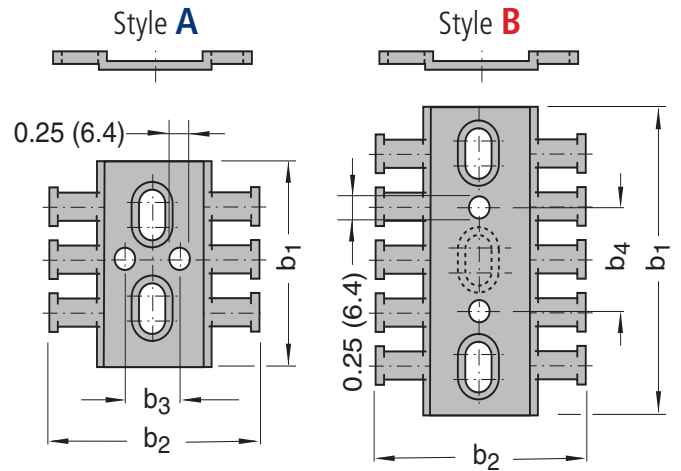
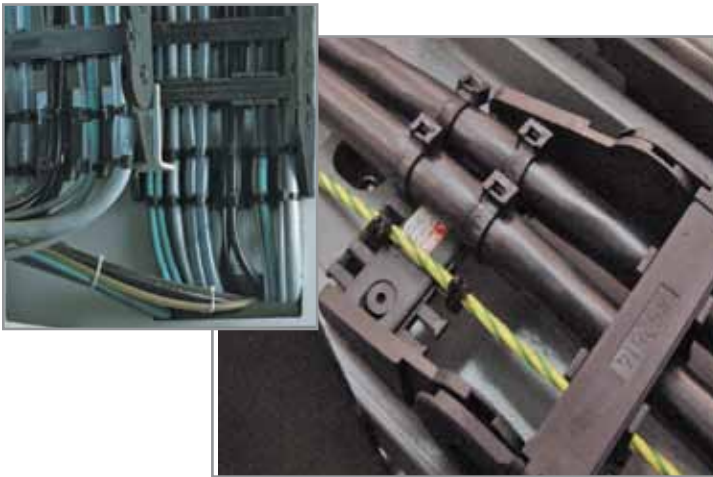

Dimensions in inches (mm)

Part #	b1	b2	b3	b4	# of Tines	Style
52480	1.97 (50)	2.09 (53)	0.55 (14)	---	3	A
52485	2.56 (65)	2.09 (53)	0.55 (14)	---	4	A
52490	2.76 (70)	2.76 (70)	0.79 (20)	---	4	A
52481	2.76 (70)	2.09 (53)	---	0.59 (15)	4	B
52482	3.54 (90)	2.09 (53)	---	1.38 (35)	6	B
52483	4.53 (115)	2.09 (53)	---	2.36 (60)	8	B
52484	5.59 (142)	2.09 (53)	---	3.43 (87)	10	B
52486	3.54 (90)	2.09 (53)	---	0.98 (25)	6	B
52487	4.53 (115)	2.09 (53)	---	1.97 (50)	7	B
52488	5.51 (140)	2.09 (53)	---	2.92 (75)	10	B
52489	6.50 (165)	2.09 (53)	---	0.39 (10)	12	B
52491	3.74 (95)	2.76 (70)	---	0.79 (20)	6	B
52492	4.72 (120)	2.76 (70)	---	1.57 (40)	8	B
52493	5.71 (145)	2.76 (70)	---	2.56 (65)	10	B
52494	6.69 (170)	2.76 (70)	---	3.54 (90)	12	B
52495	7.68 (195)	2.76 (70)	---	4.53 (115)	14	B
52496	8.66 (220)	2.76 (70)	---	5.51 (140)	16	B
52497	9.65 (245)	2.76 (70)	---	6.50 (165)	18	B
52498	10.63 (270)	2.76 (70)	---	7.48 (190)	20	B

Specifications are subject to change without notice.
KSA-0810-GC

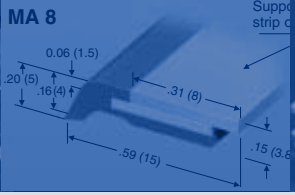
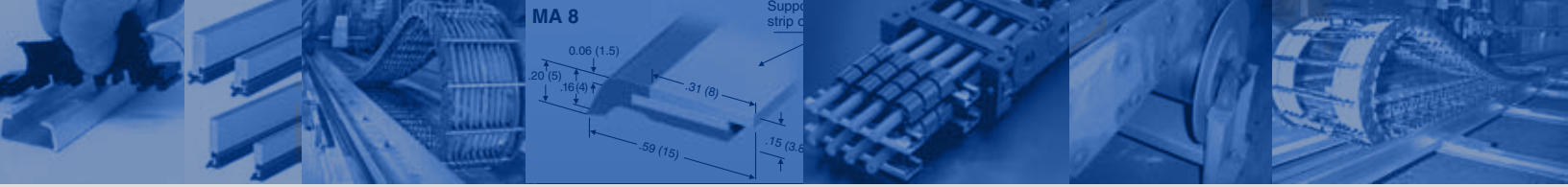

DIN Rails/U-Channels

If there is no flat surface available to bolt down KabelSchlepp clamping systems off either end of the cable and hose carrier system - or - if other cable and hose clamps are going to be used - or - if several such components are to be used in tandem or unison, DIN rails or U style channels can be used and purchased from KabelSchlepp America.

Call your KabelSchlepp factory representative at 1-800-443-4216 for complete information and design assistance!



Cable and Hose Carrier Support & Guidance Systems

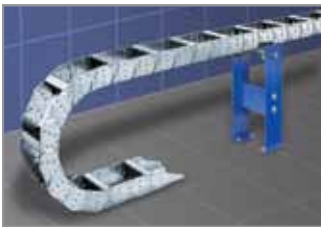

Support Rollers

Stationary support rollers can substantially increase travel capabilities in applications where the cable and hose carrier system's unsupported span is exceeded. See product and design details in our Technical Handbook section of this catalog or call your KabelSchlepp factory representative at 1-800-443-4216 for complete information and design assistance!



Support Trays

Use of KabelSchlepp support trays will ensure that your application has an even, flat and clear surface which is needed for the optimal and safe operation of your cable and hose carrier system. Standard systems are made of zinc plated steel. Stainless steel and other special materials and coatings are available upon request. See product and design details in our Technical Handbook section of this catalog or call your KabelSchlepp factory representative at 1-800-443-4216 for complete information and design assistance!



Single Piece Design
Standard design, suitable for most applications.



Split Rail Design:
Allows air-flow, dirt and debris to pass through trays.



Guide Channels

This cost effective solution should be used to properly guide and support cable and hose carrier systems in long travel gliding applications, mounted to the ground or on a supporting structure off the ground. Standard from-stock zinc plated steel as well as Made-To-Order aluminum and stainless steel systems are available. See product and design details in our Technical Handbook section of this catalog or call your KabelSchlepp factory representative at 1-800-443-4216 for complete information and design assistance!

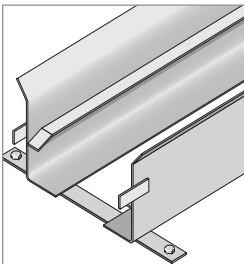

Open-Bottom:
Most economical, allows air-flow, dirt and debris to pass through channel.

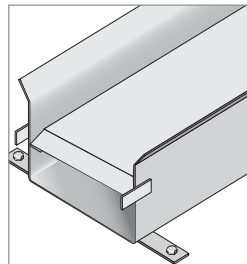

Closed-Bottom:
Traditional design, has solid glide plate across the bottom.

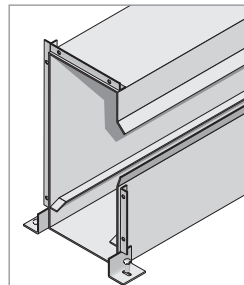

Hooded:
Keeps most debris from damaging chain in channel.

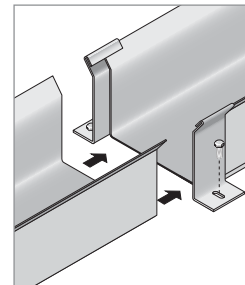

Side Flanges:
One Piece - Keeps side walls in alignment.

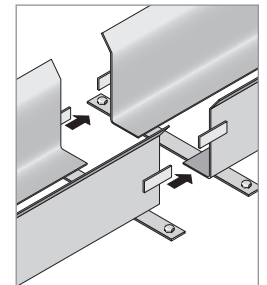

Side Clips:
Clips keep side walls in alignment.

Extended Travel Support Systems



KabelSkate^{KS}

Designed for use on extremely long travel and heavy systems. This patented system offers an ultra-light weight, cost-effective and simple solution with the highest degree of functional safety and reliability.

- No guide channel is required
- Self-alignment of cable and hose carrier system
- Minimal number of components
- 500 meter travel capabilities
- Light weight = Reduced motor size = less cost



DynaGlide^{KS}

Designed for use on extra long travel and heavy steel chain systems. This system offers an alternative to Rolling Carriage Systems by using the proven gliding technology of polymer systems. See product and design details in our Technical Handbook section of this catalog or call your KabelSchlepp factory representative at 1-800-443-4216 for complete information and design assistance!

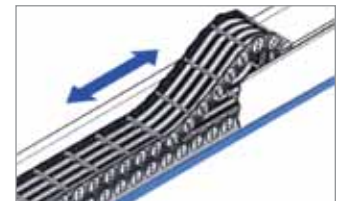

Rolling Carriage Systems

KabelSchlepp Rolling Carriage Systems can be used in situations where normal self-supporting or gliding operation is not possible due to travel length, weight, acceleration or travel speed. The extra support and reduced friction of Rolling Carriage Systems make them particularly well suited for large load applications that have long travel lengths and high speeds. See product and design details in our Technical Handbook section of this catalog or call your KabelSchlepp factory representative at 1-800-443-4216 for complete information and design assistance!



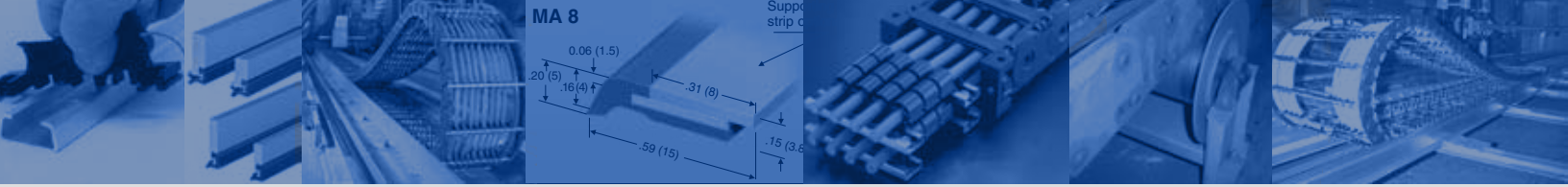

Extended Travel Support Systems (cont.) - ECC (Emergency Cable Carrier System)

Emergency Cable Carrier – Security for long travel lengths

Blockages in the travel lengths of cable carriers in large systems can destroy the entire cable carrier system. This results in high costs and downtime for the entire system. The new ECC – Emergency Cable Carrier minimizes downtimes and avoids repair costs.



Emergency Cable Carrier System with additional emergency stop system

During use in harsh environments, objects can enter the carrier's path of travel, thus blocking it. ECC detects this and switches the system off safely. In addition to the Emergency Stop function, ECC also offers a bridging safeguard for the braking distance. Areas of application: Applications with long travel lengths, e.g. crane, port, compost or coal conveyor systems, steel works and raw materials systems.



Bridging safeguard of the braking distance in both directions of travel



Automatic emergency cutout with decoupling of the cable carrier



Simply couple again; the system is ready for operation again immediately

Subject to change.

Specifications are subject to change without notice.
KSA-0810-GC

Also Available - Machinery Debris Protection Systems

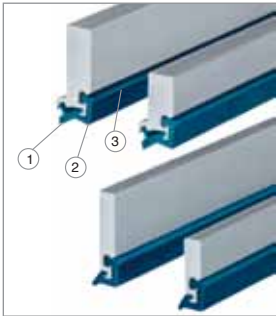

Way Wipers

The unique KabelSchlepp 3-point sealing system was developed for optimal hot chip, debris and fluid protection for all sensitive guide and slide-ways. Wiper blades are mounted on solid, light weight, non-corrosive aluminum frames and are shipped in standard 39.4" (1000 mm) straight lengths or can be fabricated to meet your exact specifications.



Dimensions in inches (mm)

Part #	Un-Mounted (stock) Height	Mounted (loaded) Height
BA 18	0.708 (18mm)	0.699 (17 mm)
BA 25	0.944 (24 mm)	0.905 (23 mm)
BAS 18	0.708 (18mm)	0.669 (17 mm)
BAS 25	0.944 (24 mm)	0.905 (23 mm)
BAS 40	1.575 (40 mm)	1.535 (39 mm)

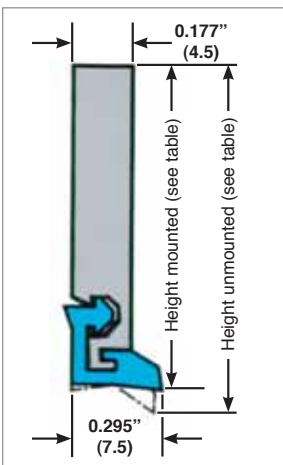

TYPE BA
Standard aluminum profile.

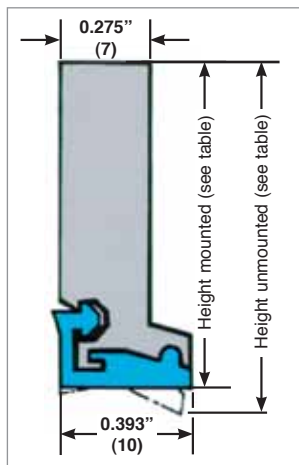

TYPE BAS
Thicker aluminum profile with lip for mounting optional hot-chip shield.

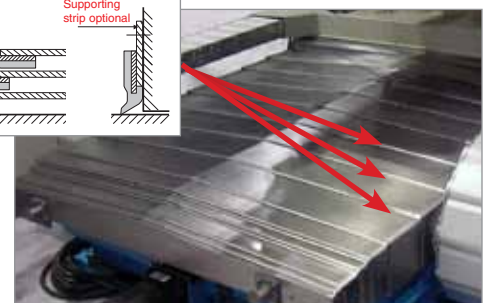
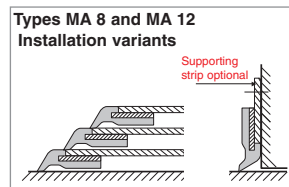

TYPE MA Box Cover Wipers
KabelSchlepp MA series wipers for telescopic box covers provide excellent abrasion resistant wiping and sealing of seams between each box segment

KS Telescopic Box Cover Wipers

Probably the best and most often asked for sealing and wiping system for metal telescoping box covers. These replacement wiper blades, chip covers and back supports can be ordered from stock and mounted to common KabelSchlepp and competitor box covers.

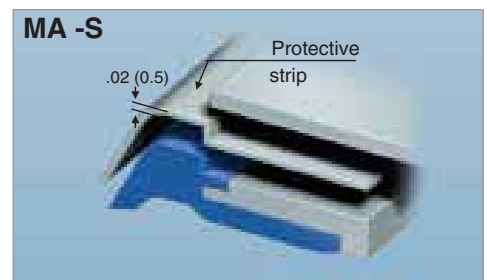
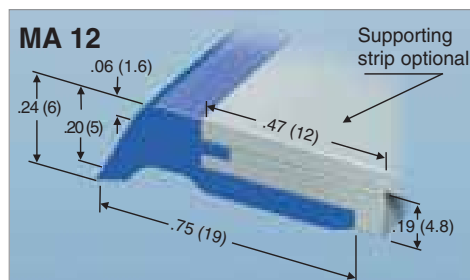
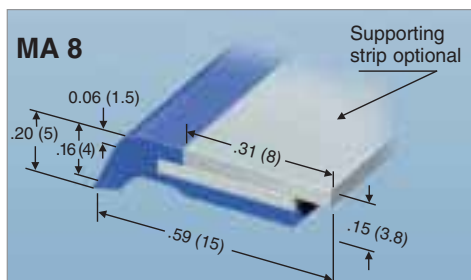

Specifications are subject to change without notice.
KSA-0810-GC

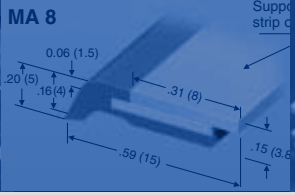
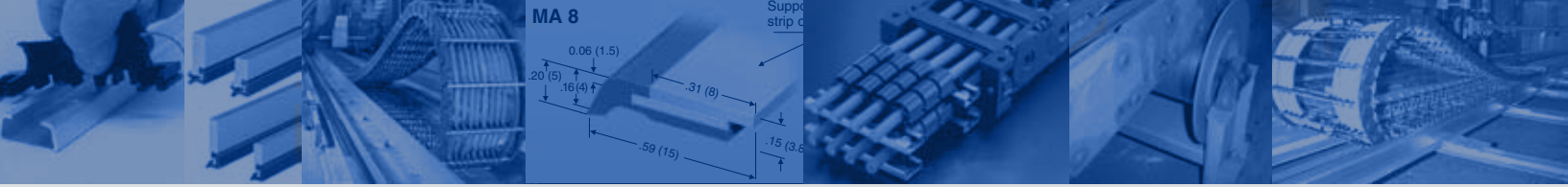

Conical Spring Covers

- Inexpensive and effective method of protecting sensitive areas on and around machinery.
- Completely enclosed design offers protection for lead screws, ball screws, hydraulic rods, die posts, and personnel.
- Dynamic telescopic action results in automatic expansion and contraction.
- No mounting clamps required.
- Mounting "seats" available.
- Made-To-Order - prompt delivery.
- Available in stainless or carbon steel.
- Good aesthetic appearance.
- Made in America.



How to determine size requirements yourself?

Cover:		(inches)
X = Inside diameter	= Shaft diameter + 0.25"	=
W = Extended length	= Max. exposed length of shaft	=
V = Collapsed length	= Min. exposed length of shaft	=
Y = Stroke	= W - V	=
Z = Outside diameter	= Max. allowable area	=

Tolerances: X = +.094/- .000 Z = +.000/- .125

Flanges:	(inches)
A = X - 0.25"	=
B = V x 0.75"	=
C = Z	=
D = Z + 0.125"	=
E = Z + 0.375"	=
F = X - 0.188"	=

How to Order?

1. Shaft diameter = _____
2. Shaft RPM = _____
3. Shaft type = smooth, or screw, or spline
4. Minimum allowable inside diameter (**X**) = _____
5. Maximum allowable outside diameter (**Z**) = _____
6. Maximum extended length required (**W**) = _____
7. Maximum collapsed length required (**V**) = _____
8. Stroke (travel) speed = _____
9. Cycles/min. = _____, or cycles/hour = _____
10. Application will be horizontal angular
 vertical variable
11. Operating conditions indoor outdoor wet
 dry corrosive abrasive
 high-temp magnetic pressure

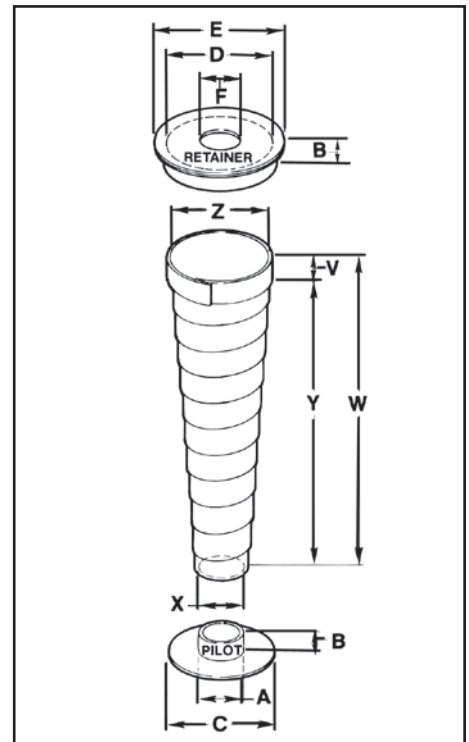

Specifications are subject to change without notice.
KSA-0810-GC

Apron Way Covers

1

Simple angle mounting of the apron can be used when the free end does not touch floor.

2

Apron Covers can be mounted by use of 90° angle and/or flat mounting brackets. Standard mounting holes are 5/16" diameter for 1/4" mounting screws. Fastening to end link of the apron cover is also possible. If necessary, a roll-up mechanism can also be employed as an option.

3

HOW TO ORDER

Please specify the required *length* and *width*. Maximum width 72". Standard aluminum mounting 90° angle (3/4" x 3/4" x 1/8") and flat brackets (1-1/4" x 1/8") riveted to the apron are available.

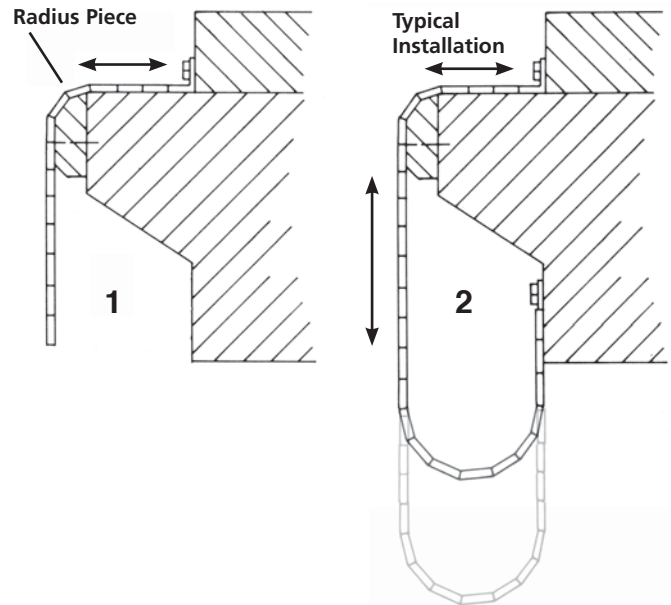
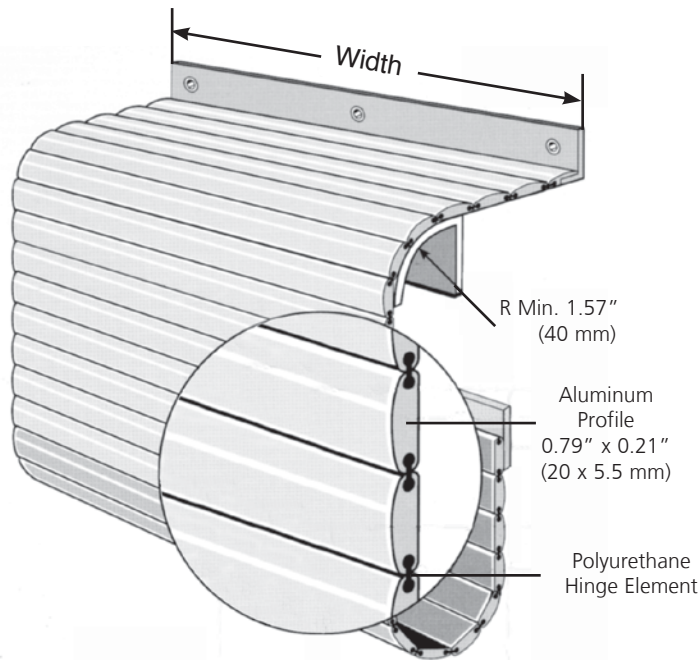
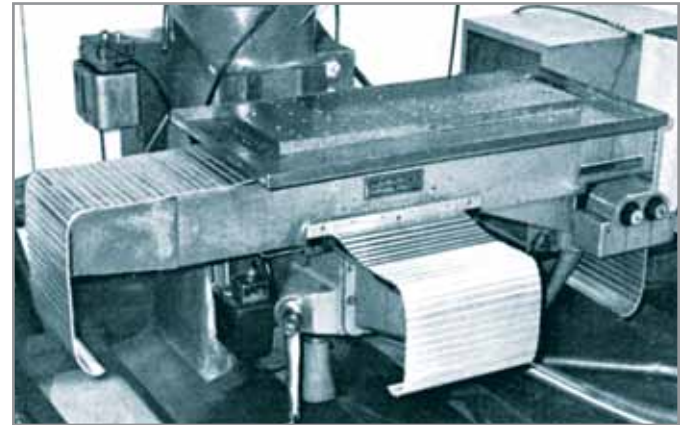

Key Advantages:

- High strength aluminum extrusions provide positive protection of machine ways from hot chips, abrasives and other wear-causing agents.
- Aluminum elements interlocked with durable, long-lasting polyurethane hinge elements.
- May be used as an alternative to a telescopic way cover.
- Requires a minimum amount of space.
- Low-cost solution to potential high-cost repair or replacement.
- Simple and quick mounting.
- Helps assure long maintenance-free guideway life.

Angle mounting bracket

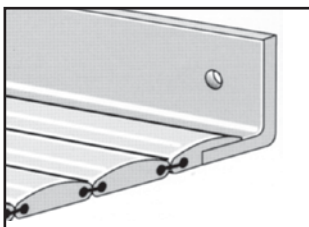

Flat mounting bracket

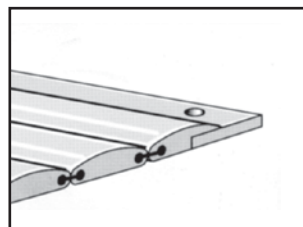

KABELSCHLEPP

A member of the TSUBAKI GROUP

www.kabelschlepp.com
sales@kabelschlepp.com
KabelSchlepp America, Inc.
7100 W. Marcia Road, Milwaukee, WI 53223 - USA

Phone: 414-354-1994
Fax: 414-354-1900